



# MANUAL



## REMOTE CONTROL & SOCKET SWITCH PLUG PET-910+MFYCR-2300

### CONTENTS

---

1. Overview and features	Page 2.
2. Battery	Page 3.
3. Pairing / Un-pairing device	Page 5.
4. Operation	Page 8.
5. Specifications	Page 9.

# 1. Overview and features

Transform your electronic devices to wireless control with the mini socket switch plug. All you have to do is plug the socket switch into an electrical outlet, plug a device into the socket switch, and control your device using a remote control.

## **Main features;**

### Socket Switch Plug:

- Compatible to L and M series'.
- 2300W maximum resistive load control.
- Plugs into any regular electrical wall outlet.
- Intuitive, easy set up. Easy to use.
- 32 memories, first in first out storage maintain.
- Scene status memory, create your desired atmosphere.

### Handy Remote (PET-910):

- 3 sets of On / Off button.
- 1 set of All Off button.
- 2 years battery life.



Not compatible to:

ARC Code switch system product range

## 2. Battery

1. With a phillips screwdriver, loosen the screw to remove battery compartment.

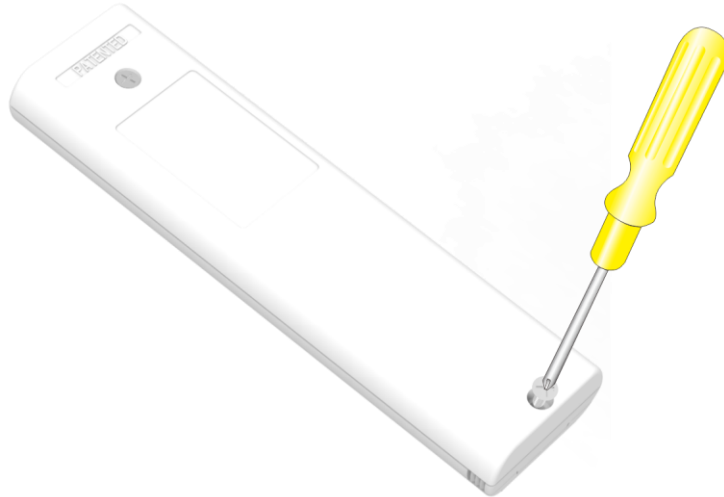

2. With a little force squeeze both side and pull out the battery compartment and remove 3V CR2032 battery.



3. Remove battery and replace a new 3V CR2032 and make sure the positive symbol is facing upwards.



4. Slide back battery compartment and tighten the screw to complete the battery installation.

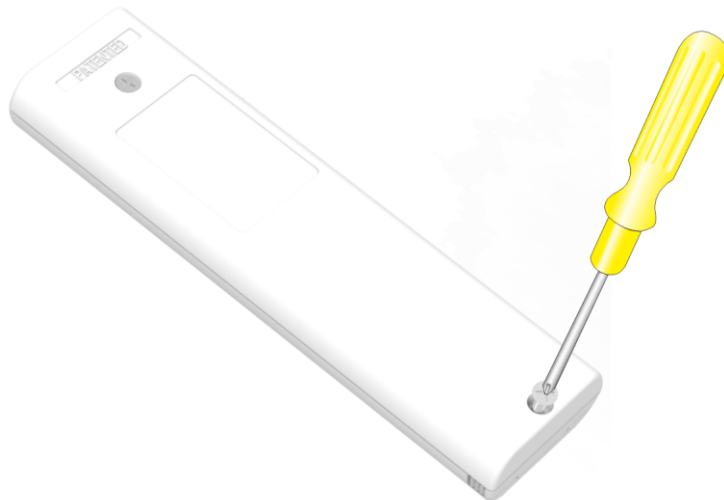

**LITHIUM BATTERY CAUTION:**

Risk of Explosion if battery is replaced by an incorrect type. Dispose of used batteries according to the environment protection rules.

### 3. Pairing / Un-pairing Device

#### PAIRING

Pairing using **LEARNING MODE**:

1. Plug in lamp / electronic device into socket switch then socket switch into an electrical outlet

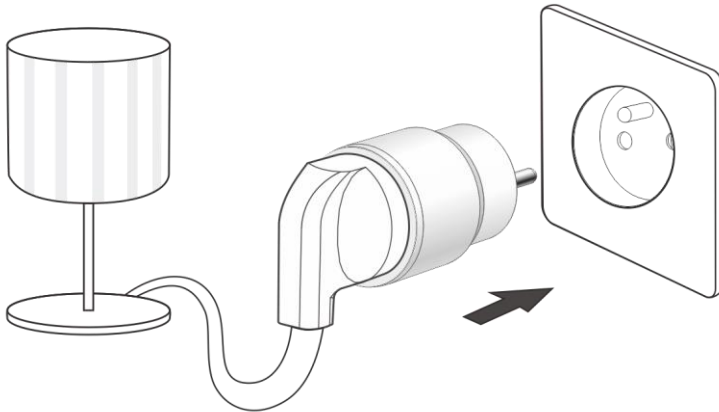

2. Within 6 seconds, on the remote control press the 'ON' button intend to be paired; load will flash twice to confirm that the remote control is now paired.

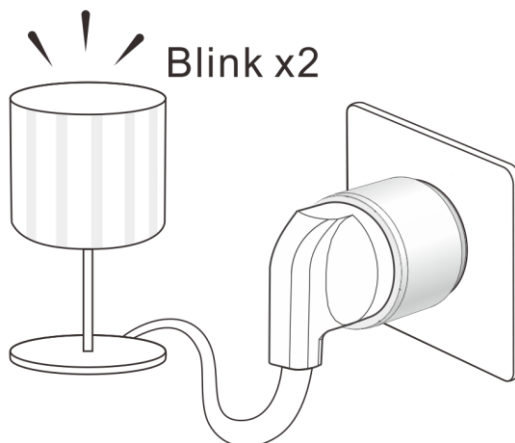

**NOTE:** If no signal is received from a remote control within 6 seconds then the socket switch will automatically exit learning mode without pairing the device.

## UN-PAIRING

### Removing single Device:

1. Unplug socket switch from the electrical outlet for at least 6 seconds.

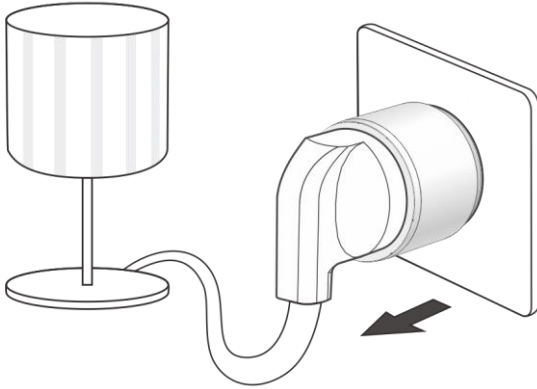

2. Plug socket switch back into electrical outlet.

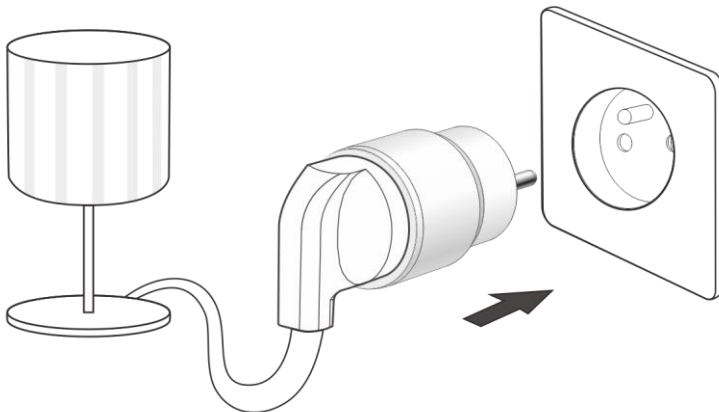

3. Within 6 seconds, on the remote control press the **'OFF'** button intend to be un-paired; load will flash twice to confirm that the remote control is un-paired.

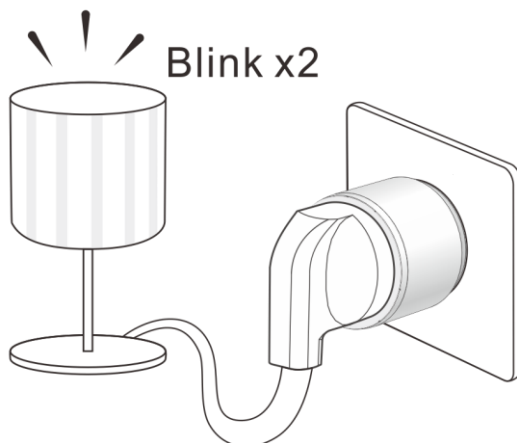

## CLEARING ALL MEMORY

Removing all memory stored in the socket switch.

1. Unplug socket switch from the electrical outlet for at least 6 seconds.

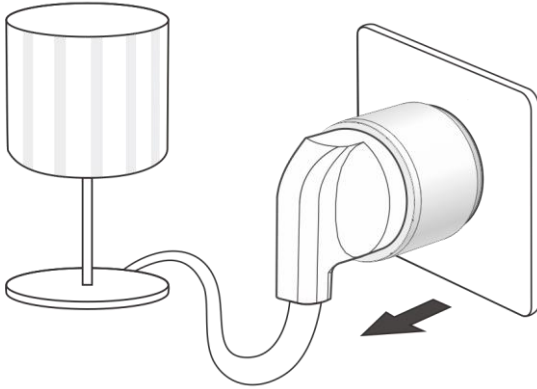

2. Plug socket switch back into electrical outlet.

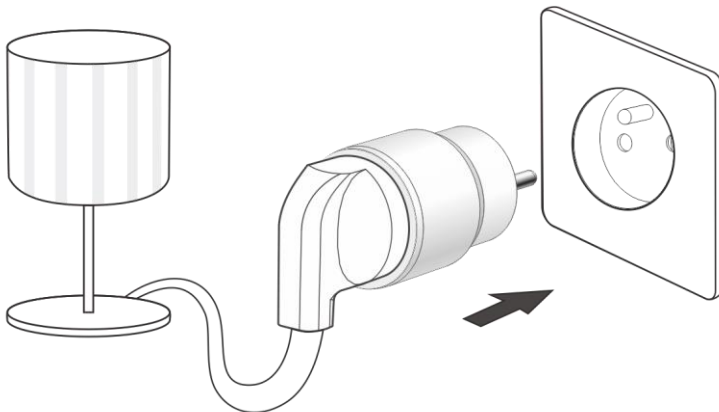

3. Within 6 seconds, on the remote control press the '**ALL OFF**' button; load will flash twice to confirm all memory stored inside the socket switch has been deleted.



## 4. Operation

### Turn the load ON:

Press '**ON**' button once, load will illuminate.

### Turn the load OFF:

Press '**OFF**' button once, load will turn Off.

### Turn all load OFF:

Press '**ALL OFF**' button once, all connected load will turn Off.





## 5. Specifications

Input Rating:	230V~50Hz
Output Rating:	2300W (Resistive Load)
Radio Frequency:	433.92MHz
Remote Control Battery:	PET-910: 3V CR2032 Lithium Cell Battery
Power consumption:	<1W
Environment Temperature:	0-40 °C
Range:	up to 50 m indoors (Depends on building materials)
In accordance with:	Low Voltage Directive 2014/35/EU RED Directive 2014/53/EU
CE Certification:	The CE marked affixed to this product confirms its compliance with the European Directives which apply to the product and in particular its compliance with the harmonized standards and specifications.



Dimension (L x W x H)	
Remote Control	111 x 30 x 13mm
Socket Switch Plug	48 x 50mm (D x H)
Weight:	
Remote Control	30 g
Socket Switch Plug	60 g

### **NOTE**

Please leave minimum of 1.5 meters in-between 2 or more socket switch.  
Battery life is calculated at an average of 20 activations per day.