



MANUAL



WIRELESS MINI DIMMER SOCKET SWITCH PLUG MYCR-250

CONTENTS

1. Overview and features	Page 2.
2. Diagrams	Page 3.
3. Pairing / Un-pairing device	Page 4.
4. Trailing & Leading Edge setup	Page 8.
5. Minimum Brightness setup	Page 9.
6. Operation	Page 10.
7. Specifications	Page 11.

1. Overview and features

Transform your electronic devices to wireless control with the mini dimmer socket switch plug. All you need to do is plug the socket switch into an electrical outlet, plug a device into the socket switch, and control your device using a remote control.

Main features;

- Compatible to L and M series'.
- 250W dimmer universal load control.
- Plugs into any regular electrical wall outlet.
- Intuitive, easy set up. Easy to use.
- Operating mode of Trailing Edge or Leading Edge.
- Minimum brightness setup for different kinds of dimmer loads.
- 32 memories, first in first out storage maintain.
- Memory of last brightness level.
- Scene status memory, create your desired atmosphere.
- Built-in manual On & Off button with LED indication.



Not compatible to:

ARC Code switch system product range

2. Diagrams

Notes for the diagrams:

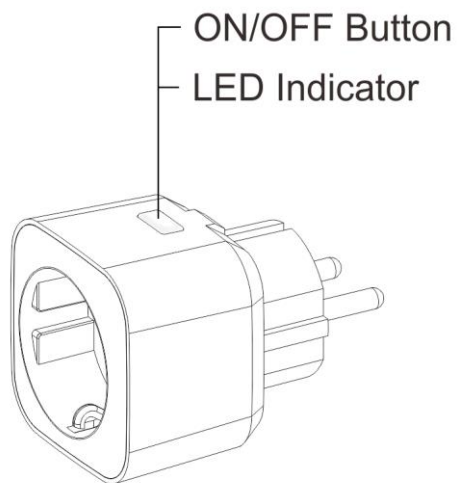

3. Pairing / Un-pairing Device

PAIRING

Pairing using **LEARNING MODE**:

1. Plug in lamp / electronic device into socket switch.

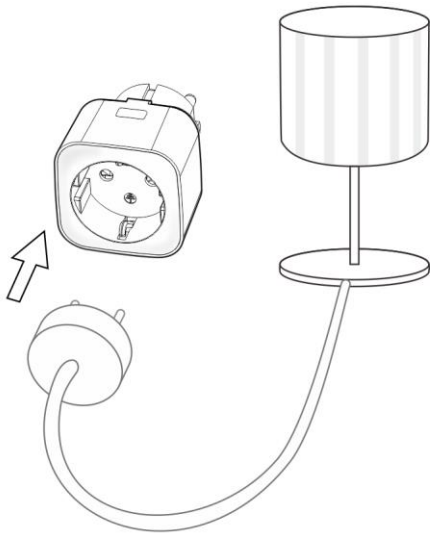

2. Plug the socket switch into an electrical outlet.

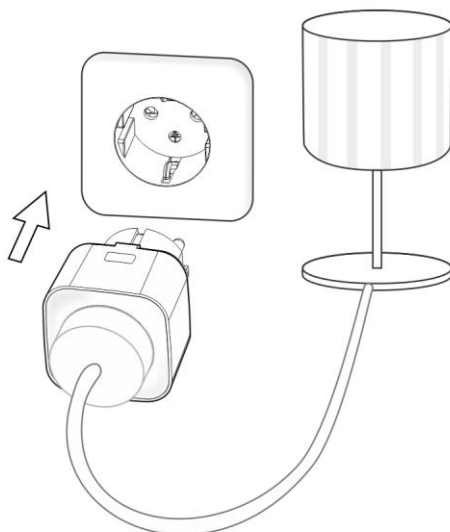

3. Within 6 seconds, on the remote control press the '**ON**' button intend to be paired; LED on socket switch will quick flash and load will flash twice to confirm that the remote control is now paired.

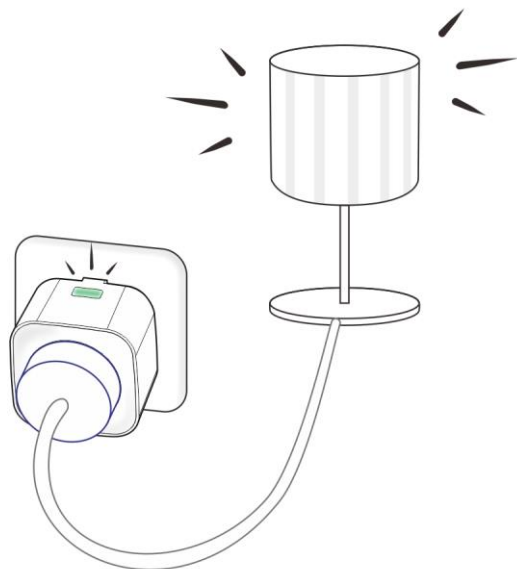

NOTE: If no signal is received from a remote control within 6 seconds then the socket switch will automatically exit learning mode without pairing the device.

UN-PAIRING

Removing single Device:

1. Unplug socket switch from the electrical outlet for at least 6 seconds.

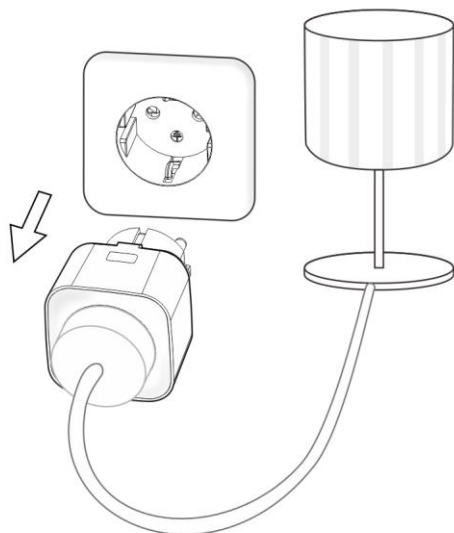

2. Plug socket switch back into electrical outlet.

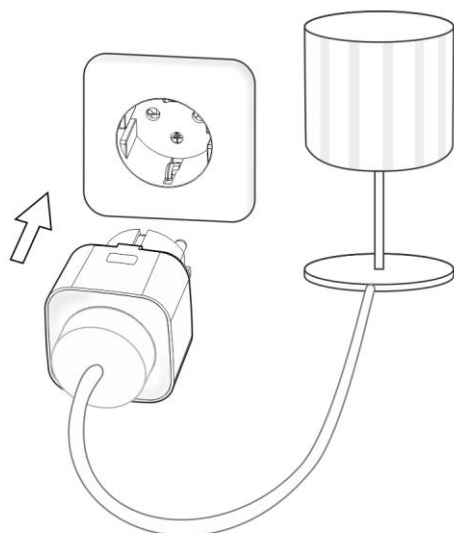

3. Within 6 seconds, on the remote control press the '**OFF**' button intend to be un-paired; LED on socket switch will quick flash and load will flash twice to confirm that the remote control is un-paired.

CLEARING ALL MEMORY

Removing all memory stored in the socket switch.

1. Unplug socket switch from the electrical outlet for at least 6 seconds.

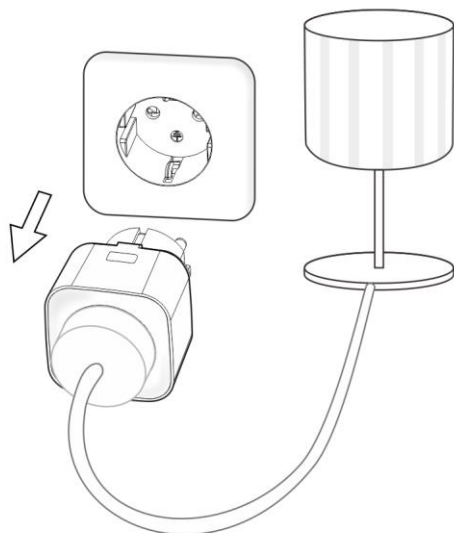

2. Plug socket switch back into electrical outlet.

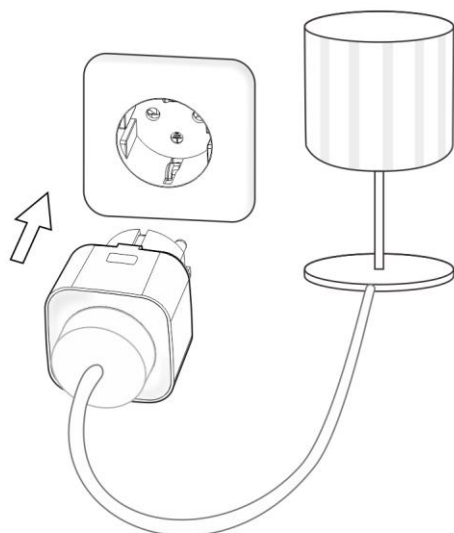

3. Within 6 seconds, on the remote control press the '**ALL OFF / GROUP ALL**' button; LED on socket switch will quick flash and load will flash twice to confirm all memory stored inside the socket switch has been deleted.

4. Trailing & Leading Edge Setup

Initial factory pre-set is at 'Leading Edge'.

Depending on the load you are using, please use the appropriate setting.

To change between Leading edge and Trailing edge, please follow below setup.

Leading Edge to Trailing Edge

1. Load must be at 'ON' status.
2. Press and hold down 'ON/OFF' button for 10 seconds.
3. LED on socket switch will flash 4 times each interval.
4. Press 'ON/OFF' button again to switch from Leading edge to Trailing edge.
5. LED on socket switch will quick flash and load will flash twice and resume to the lowest dim level to confirm Trailing Edge setup is complete.
6. After the setup is completed, each time you operate ON/OFF under Trailing Edge the LED on socket switch will flash twice.

Trailing Edge to Leading Edge

1. Load must be at 'ON' status.
2. Press and hold down 'ON/OFF' button for 10 seconds.
3. LED on socket switch will flash 4 times each interval.
4. Press 'ON/OFF' button again to switch from Trailing edge to Leading edge.
5. LED on socket switch will quick flash and load will flash twice and resume to the lowest dim level to confirm Leading Edge setup is complete.
6. After the setup is completed, each time you operate ON/OFF under Leading Edge the LED on socket switch will flash once.

5. Minimum Brightness Level Setup

Socket switch has the ability to setup minimum brightness level for both Leading or Trailing Edge.

There are total 4 level brightness to choose from.

To adjust the brightness level, please follow below setup.

With a remote control (LYCT-505)

1. Load must be at 'ON' status.
2. Press and hold down Manual 'ON/OFF' button on socket switch for 3 seconds.
3. LED on socket switch will flash twice each interval.
4. Use a remote control and press 'ON' to dim up on level or press 'OFF' button to dim down one level. There are only 4 levels to adjust.
5. Once you have decided the brightness level, press the Manual 'ON/OFF' button on socket switch once.
6. LED on socket switch will quick flash and load will flash twice and resume to the lowest dim level. This completes the brightness level setup.

With a one button remote control (MKFT-1704 / MEBT-1706)

1. Load must be at 'ON' status.
2. Press and hold down Manual 'ON/OFF' button on socket switch for 3 seconds.
3. LED on socket switch will flash twice each interval.
4. Use a remote control and press 'ON/OFF once' to dim up on level or press 'ON/OFF' button twice to dim down one level. There are only 4 levels to adjust.
5. Once you have decided the brightness level, press the Manual 'ON/OFF' button on socket switch once.
6. LED on socket switch will quick flash and load will flash twice and resume to the lowest dim level. This completes the brightness level setup.

6. Operation

Socket switch is compatible to “Self Learning” system and M series remote control. Please refer to the relevant user guide for detailed operation.

Manual ON & Manual OFF

Operation under Leading Edge

Turn the load ON:

Press the ‘ON/OFF’ button once, LED on socket switch will flash once.

Turn the load OFF:

Press the ‘ON/OFF’ button once, LED on socket switch will flash once.

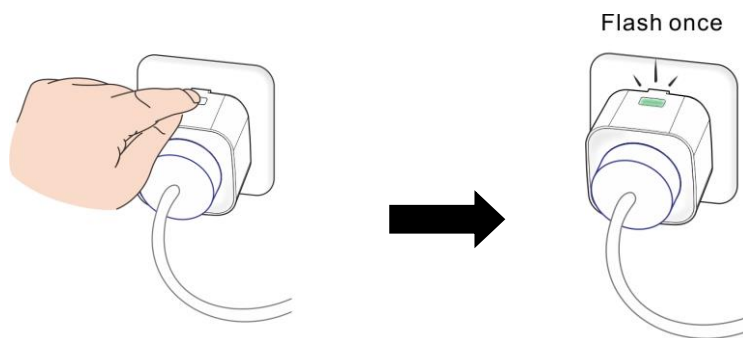

Operation under Trailing Edge

Turn the load ON:

Press the ‘ON/OFF’ button once, LED on socket switch will flash twice.

Turn the load OFF:

Press the ‘ON/OFF’ button once, LED on socket switch will flash twice.

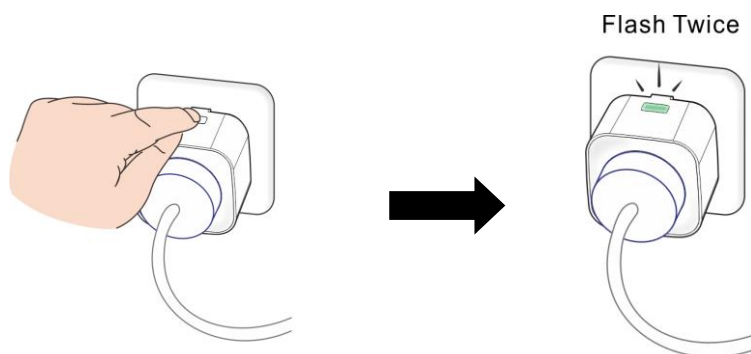

7. Specifications

Input Rating: 230V~50Hz

Output Rating:

Supported Load	Wattage
“Trailing edge” for resistive loads (R) <ul style="list-style-type: none"> Conventional incandescent and halogen light source 	20-250W / 230V~
“Trailing edge” for resistive-capacitive loads (RC) <ul style="list-style-type: none"> Electronic transformers Dimmable LED and energy saving lamps. 	20-250W / 12V~ 3-120W / 230V~
“Leading edge” for resistive-inductive loads (RL) <ul style="list-style-type: none"> Inductive transformers 	40-250W / 12V~

Radio Frequency: 433.92MHz

Power consumption: <1W

Environment Temperature: 0-40 °C

Range: up to 50 m indoors (Depends on building materials)

In accordance with: Low Voltage Directive 2014/35/EU

RED Directive 2014/53/EU

CE Certification: The CE marked affixed to this product confirms its compliance with the European Directives Which apply to the product and in particular its compliance with the harmonized standards and specifications.



Dimension (L x W x H)

53 x 53 x 58.4mm

Weight:

60 g

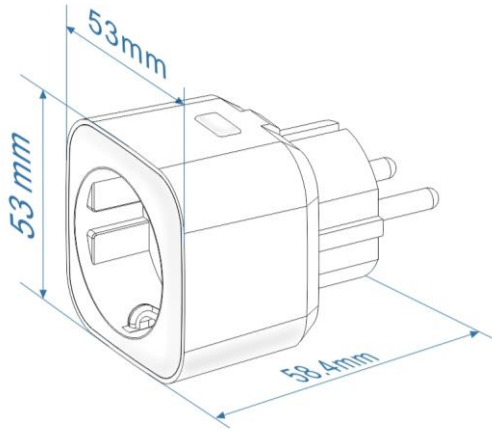

NOTE

- Please leave minimum of 1.5 meters in-between 2 or more socket switch.
- During standby mode, LED on module will not illuminate.