



MANUAL



**WIRELESS MINI DIMMER
BULB RECEIVER
MBUR-2724**

Overview and features

Wireless dimmer bulb receiver for E27 LED.

Simply twist into any E27 light fixture to control On/Off/ Dimmer wirelessly.

Main features;

- Compatible to L and M series.
- 24W dimmer LED control.
- Minimum brightness setup.
- 32 memories, first in first out storage maintain.
- Memory of last brightness level.
- Scene status memory, create your desired atmosphere.

 Not compatible to:

- ARC Code switch system product range

Operation

SUITABLE LIGHTING FIXTURE

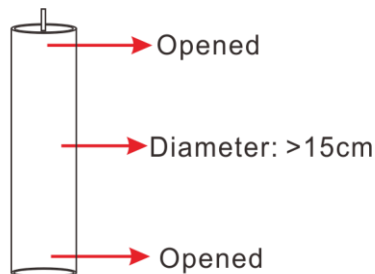
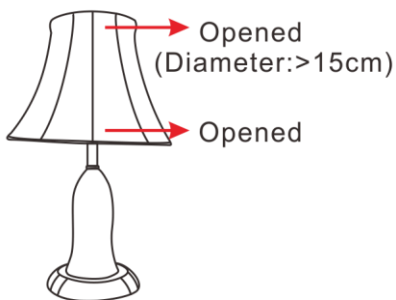

UN-SUITABLE LIGHTING FIXTURE

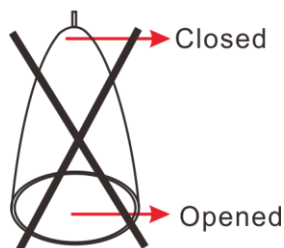
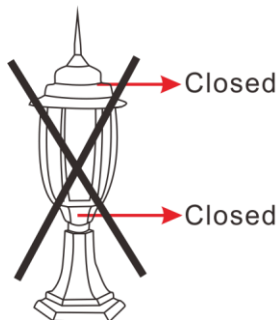

PAIRING

NOTE: If no signal is received from a remote control within 6 seconds then dimmer bulb receiver will automatically exit pairing / unpairing mode.

 Cut off main power before operation.

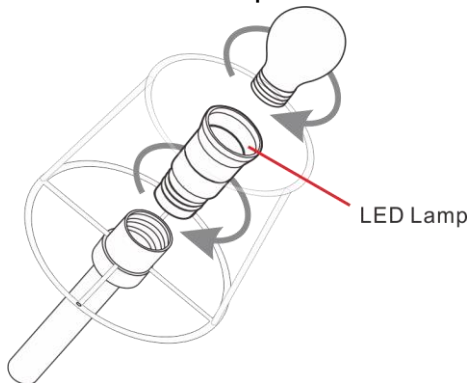

1. Twist LED onto mini bulb receiver then onto lighting fixture.
2. Power **'ON'** lighting fixture then within 6 seconds, press the **'ON'** button on the remote control; load will flash twice to confirm that the remote control is now paired.

UN-PAIRING

Removing single device:

1. Power **'OFF'** lighting fixture for at least 6 seconds, then
2. Power back **'ON'** lighting fixture then within 6 seconds, press the **'OFF'** button on the remote control; load will flash twice to confirm that the remote control is now un-paired.

Clearing all memory:

Removing all memory stored in the mini bulb receiver.

1. Power **'OFF'** lighting fixture for at least 6 seconds, then
2. Power back **'ON'** lighting fixture then within 6 seconds, press the **'ALL OFF / GROUP ALL'** button on the remote control; load will flash twice to confirm that all memory stored inside the mini bulb receiver has been deleted.

MINIMUM BRIGHTNESS LEVEL SETUP

There are total 4 level brightness to choose from.

To adjust the brightness level, please follow below setup.

1. Power '**OFF**' lighting fixture for at least 6 seconds, then
2. Power back '**ON**' lighting fixture then within 3 seconds, press and hold down the '**ON**' button on the remote control for 3 seconds then release.
3. Press '**ON**' to dim up on level or press '**OFF**' button to dim down one level. There are only 4 levels to adjust.
4. Once you have decided the brightness level you may press and hold down the '**ON**' button on the remote control for 3 seconds to save the brightness level or leave it without sending any signal for 10 seconds to save brightness level automatically.
5. Load will flash twice and resume to the lowest dim level. This completes the brightness level setup.

With a one button remote control (MKFT-1704 / MEBT-1706)

1. Power '**OFF**' lighting fixture for at least 6 seconds, then
2. Power back '**ON**' lighting fixture then within 3 seconds, press and hold down button for 3 seconds then release.
3. Press button once to dim up on level or press button twice to dim down one level. There are only 4 levels to adjust.
4. Once you have decided the brightness level you may press and hold down button for 3 seconds to save the brightness level or leave it without sending any signal for 10 seconds to save brightness level automatically.
5. Load will flash twice and resume to the lowest dim level. This completes the brightness level setup.

ON/OFF/DIMMING OPERATION



Turn the load ON:

Press '**ON**' button on remote control.

Turn the load OFF:

Press '**OFF**' button on remote control.

M Series dimming Up & Down:

✘ During dimming process when the load level reaches to the minimum or maximum bright it will stop, to continue dimming release button then press button again to start dimming.

! After setting brightness level, the next time switching ON the load will return to the previous stipulated brightness.

1. With the load ON.
2. Press the ON button once, the load will start to dim up.
3. To stop at the desire brightness level press the ON button again.
4. Next time dimming the load by pressing the ON button once, the load will

start to dim down, this is the opposite result of the last time dimming.

※For example this time the load dims up and stop, the next time dimming will be dim down.

5. During dimming process load will stop at either maximum or minimum brightness and will not continue dimming.
6. To continue dimming repeat step 2-3.

Specifications

Input Rating:	230V~50Hz
Output Rating:	≤24W LED
Radio Frequency:	433.92MHz
Power consumption:	<1W
Environment Temperature:	0-40 °C
Range:	up to 50 m indoors (Depends on building materials)
In accordance with:	Low Voltage Directive 2014/35/EU RED Directive 2014/53/EU
CE Certification:	The CE marked affixed to this product confirms its compliance with the European Directives which apply to the product and in particular its compliance with the harmonized standards and specifications.



NOTE

- Please leave minimum of 1.5 meters in-between 2 or more modules.